

NOTED FOR INFORMATION

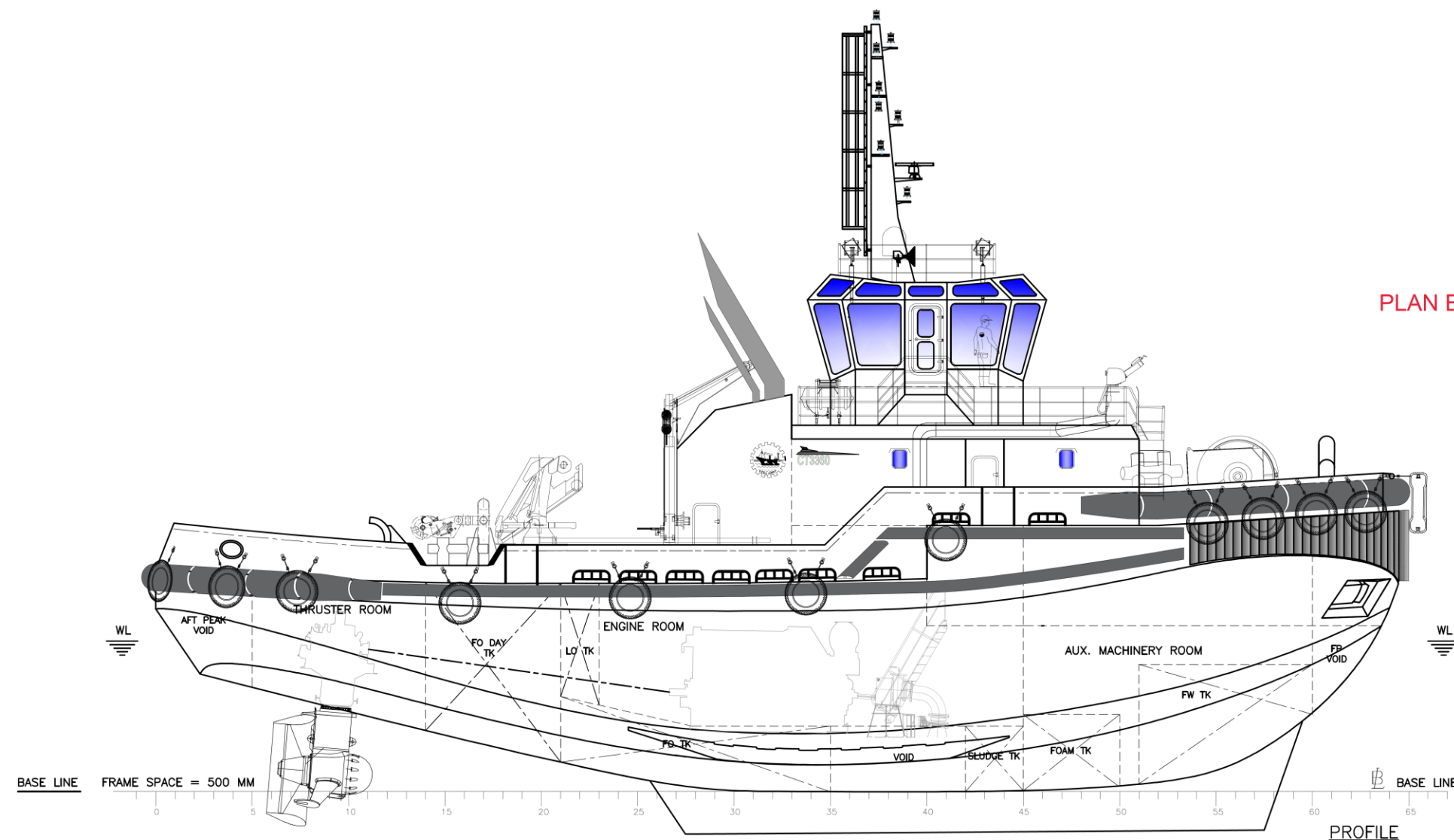

12-SEP-2021

PLAN ENDORSED FOR IN-PRINCIPLE APPROVAL



PROFILE

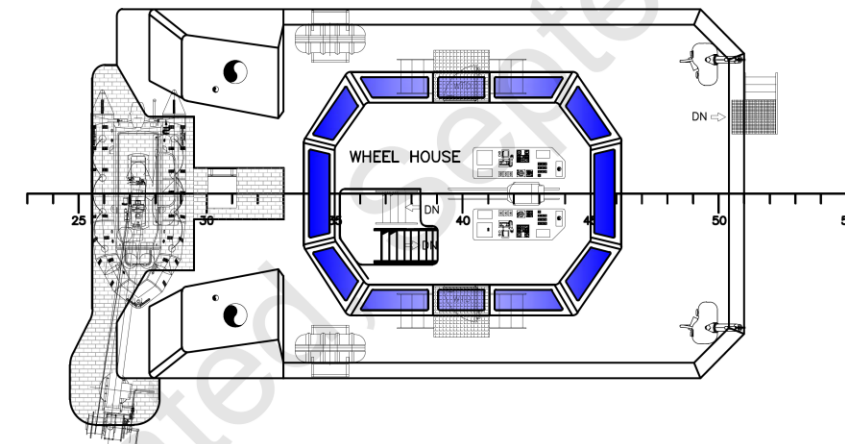

BRIDGE DECK - 9500 A/B

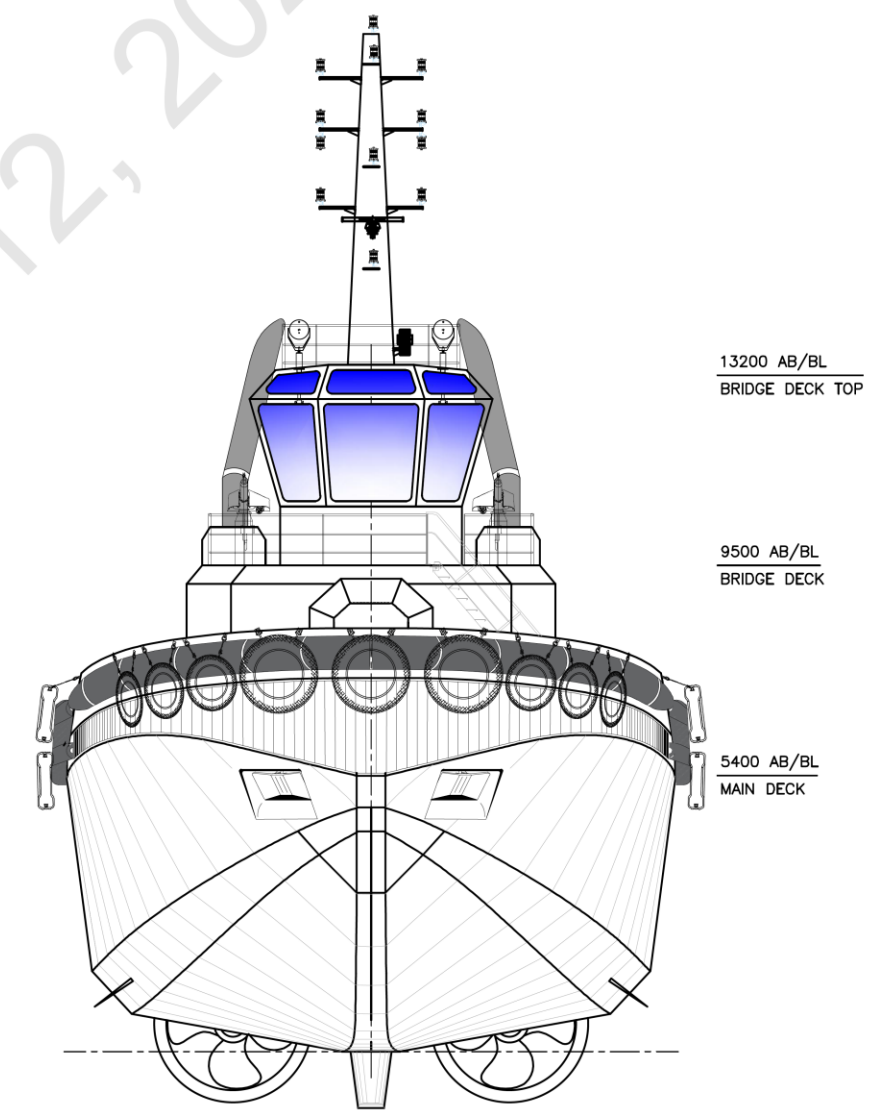

FRONT VIEW

13200 AB/BL  
BRIDGE DECK TOP

9500 AB/BL  
BRIDGE DECK

5400 AB/BL  
MAIN DECK

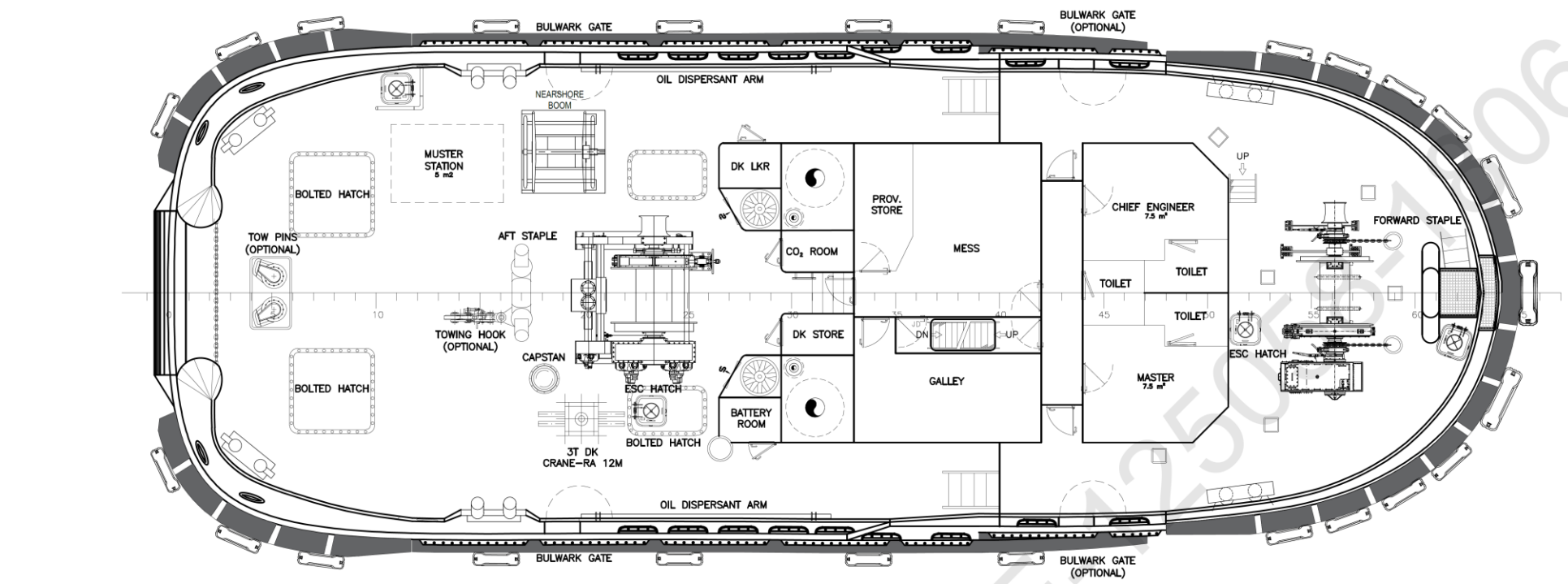

MAIN DECK - 5400/6900 A/B

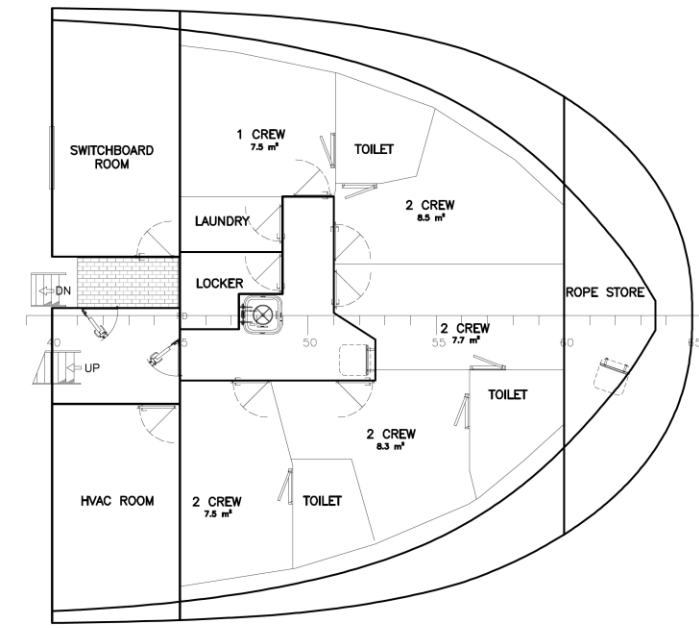

LOWER ACCOMMODATION - 4300 A/B

MAIN PARTICULARS

LENGTH O.A	.....	abt 33.0 [m]
LENGTH B.P	.....	abt 31.0 [m]
BREADTH (MLD)	.....	abt 11.9 [m]
DEPTH (MLD)	.....	abt 5.4 [m]
DRAFT (HULL)	.....	abt 3.9 [m]
COMPLEMENT	.....	11 PERSONS

BOLLARD PULL	.....	60 T @100% MCR
INSTALLED POWER	.....	abt 3600 [kW]

CLASS NOTATION ..... IRS - SWASTIKA SUL, TUG  
SWASTIKA IV, AGNI 1 (2400 m<sup>3</sup>/hr)

NOTES

1. Separate approval to be taken prior to construction for all applicable plans including LSA, LSS, Doors, Accommodation & Ventilation, Freeboard, bow height etc.
2. Emergency source of power (batteries), associated transforming equipment, if any, transitional source of emergency power, emergency switchboard and emergency lighting switchboard are to be placed suitably (preferably inside a battery room) above main deck, aft of collision bulkhead.
3. External FIFI system indicated in the GA corresponds to configuration 1 as per technical specification (Drw No : CT3360-100-006) & external FIFI system drawing (Drw No : CT3360-B14-001). This configuration may be changed based on mutual agreement between the buyer & the builder . Separate class approval to be taken for external FIFI system in such cases.
4. Full penetration weld to be provided in way of common boundaries of Foam Tank/ Dispersant Tank with any other tank.
5. Height of ventilators to be in accordance with approved prelim. stability report (Drw No : CT3360-101-009)

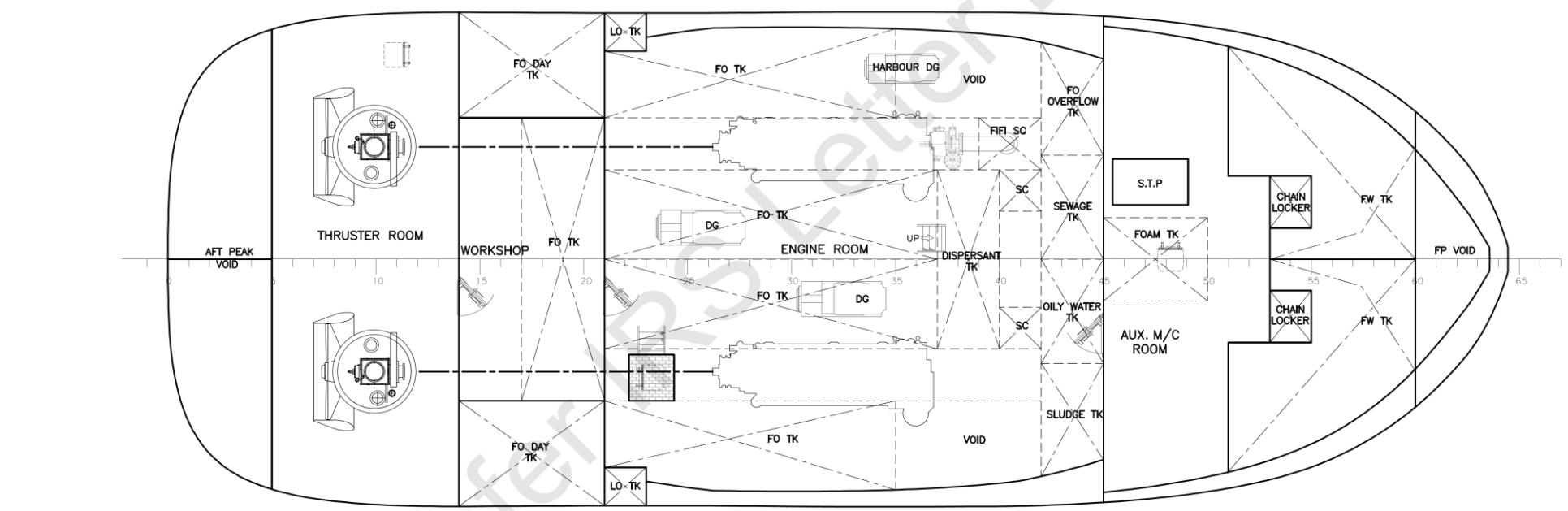

HOLD PLAN

Rev. I	30-Aug-2021	For publishing on IPA website	AAB	ABK	HUR
No:	Date	Description	Drawn	Checked	Approved
ASTDS		60T BP TUG			
DESIGN NO: CT3360		TITLE <b>GENERAL ARRANGEMENT</b>			
<b>COCHIN SHIPYARD LIMITED</b> P.O. Bag 1653, COCHIN-682015, INDIA		1:140	A2	CT3360	CT3360-101-001
		Scale	Format	Project No.	Dwg. no.

This design was developed by Cochin Shipyard Ltd. for Indian Ports Association as a part of ASTDS Package . CSL does not make any representation or warranties , express or implied as to the completeness, accuracy, suitability of the design and It shall be the responsibility of the respective builder/end-user to make its own assessment / evaluation of any such completeness, accuracy, suitability of the design prior to construction and any consequence thereof.