

Ref. Table No. 6.1 of Page 109 - Drawings / Charts at Sl. No. 1 to 10

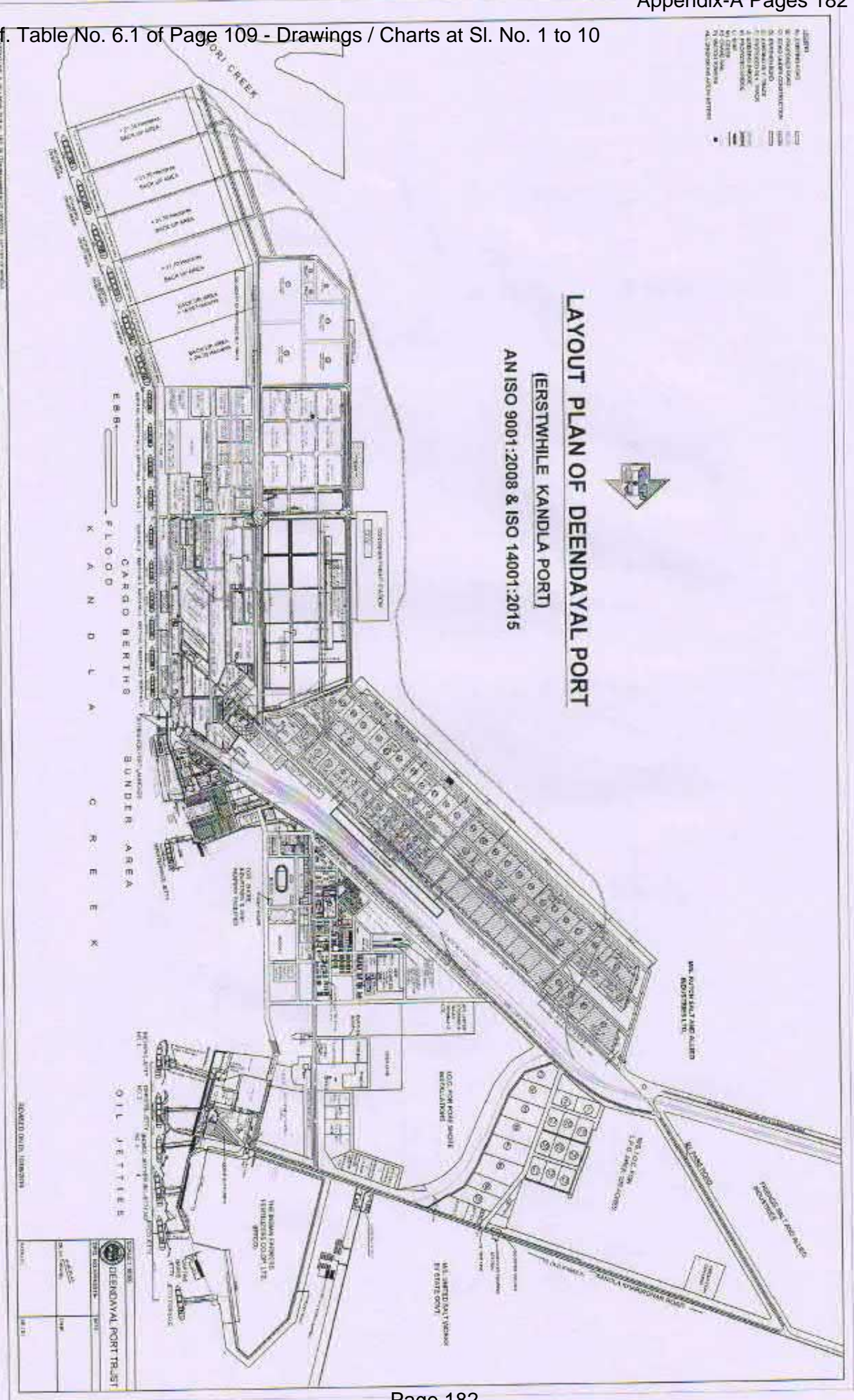

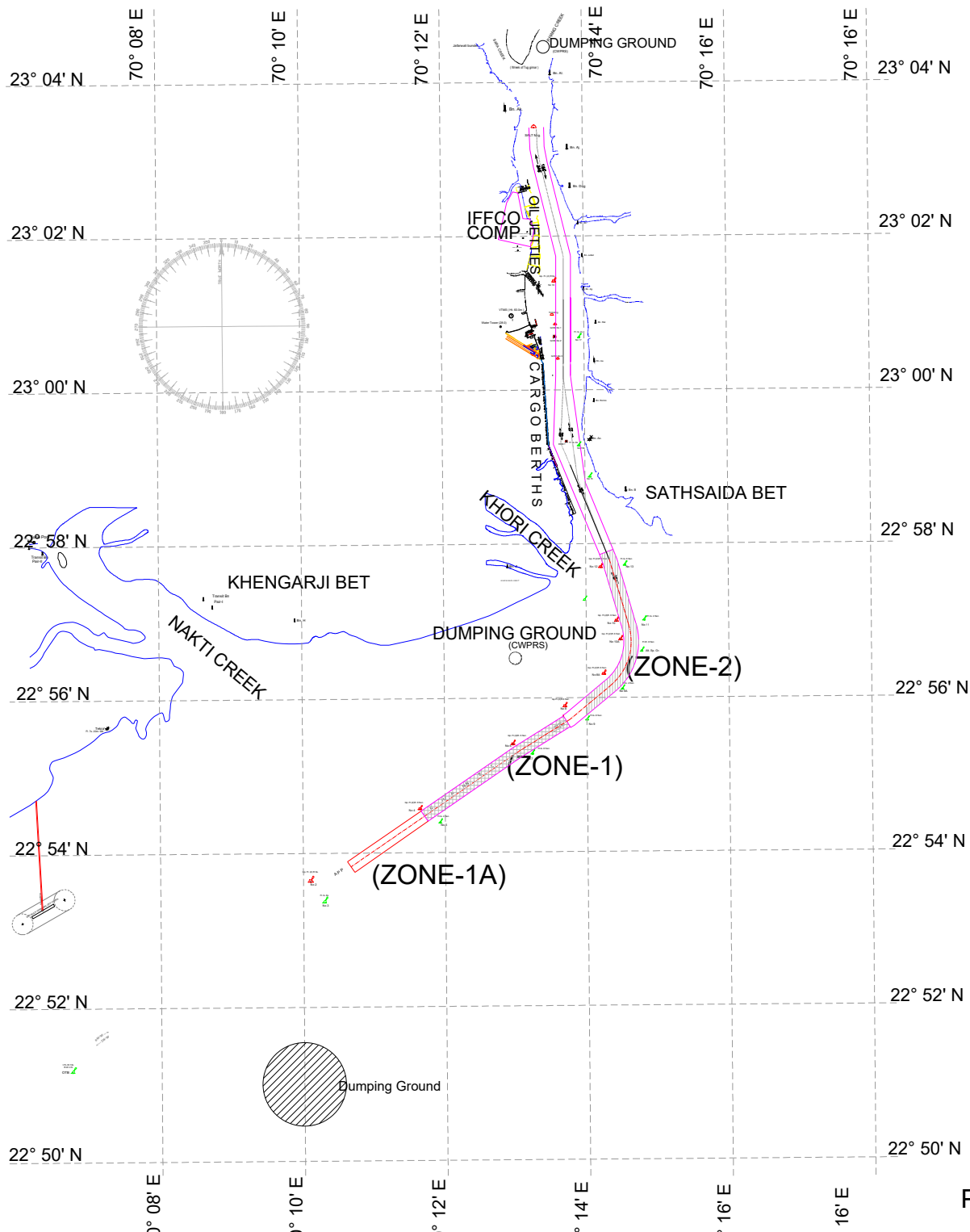

REV.	DATE	DESCRIPTION	DR.	CHK.	APP.
REVISION DETAILS					
OWNER: DEENDAYAL PORT TRUST					
PROJECT: DREDGING IN THE NAVIGATIONAL CHANNEL & ALONGSIDE CARGO BERTHS/OIL JETTIES AT DEENDAYAL PORT TRUST FOR THE YEARS 2020-2023					
PART/DISCIPLINE: _____ DIMENSIONS ARE IN: _____					
PURPOSE:					
DRAWING TITLE: DREDGING IN NAVIGATIONAL AREAS & BERTHS OF DEENDAYAL PORT					
DRAWING NUMBER: _____ REV: _____					
AECOM-P&M-60619769-DWG-1010					

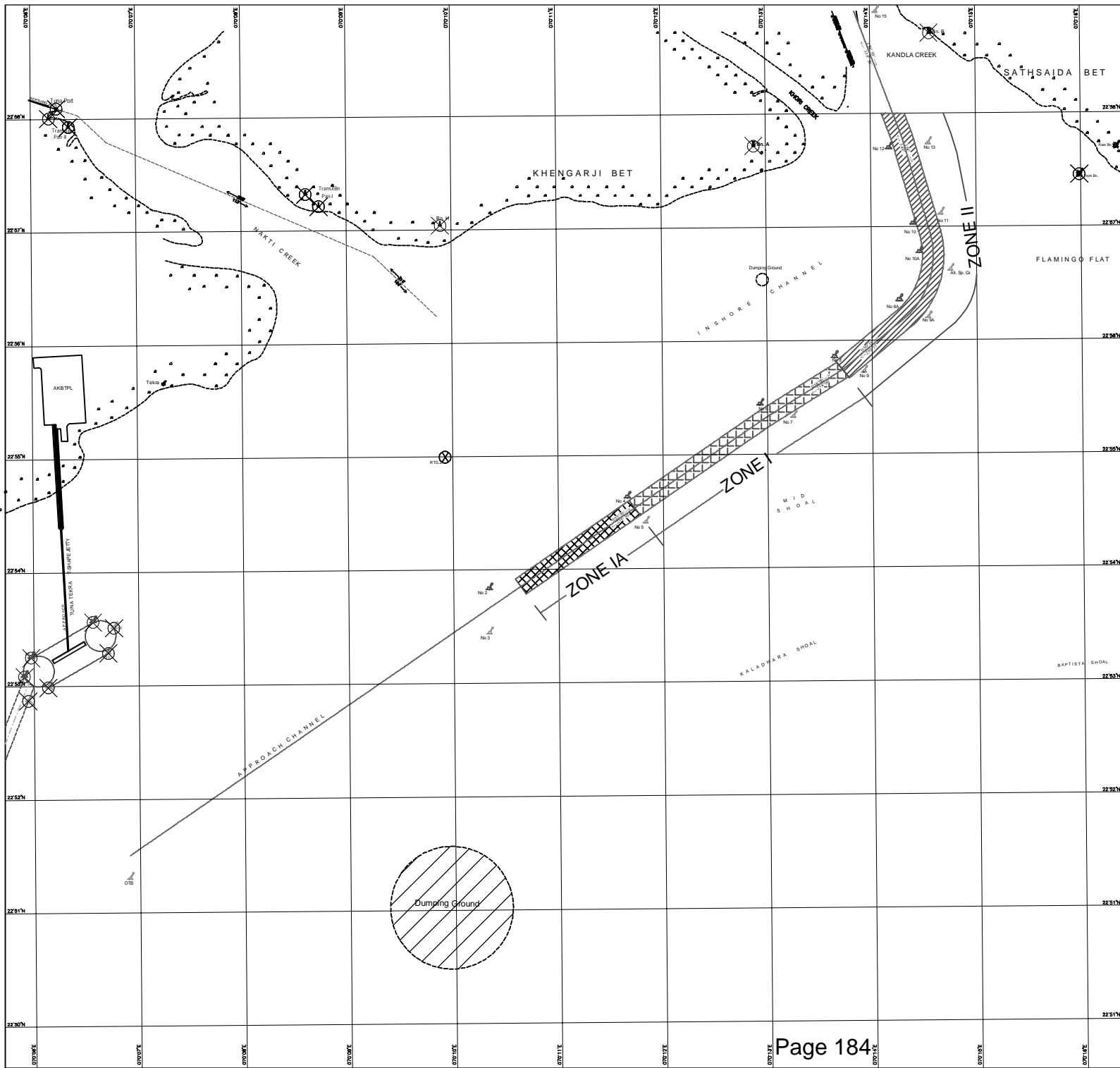

NOT SUITABLE FOR NAVIGATION
EXCEPT WHEN USED BY PORTS PILOTS

INDIA WEST COAST
GULF OF KACHCHH
DEENDAYAL PORT TRUST
APPROACHES TO KANDLA CREEK

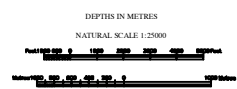

DREDGING IN THE NAVIGATIONAL
BERTHS / OIL JETTIES AT DEENDAYAL
CHANNEL AND ALONGSIDE CARGO
PORT TRUST YEAR 2020-2023

- NOTES :-
- LOCATION OF ZONE II, ZONE I AND ZONE IA
 - ZONE II LENGTH = 4.8km WIDTH = 350m
 - ZONE I LENGTH = 4.1km WIDTH = 300m
 - ZONE IA LENGTH = 2.25km, WIDTH=300m

Drawing Number :
AECOM-P&M-60619769-DWG-1027

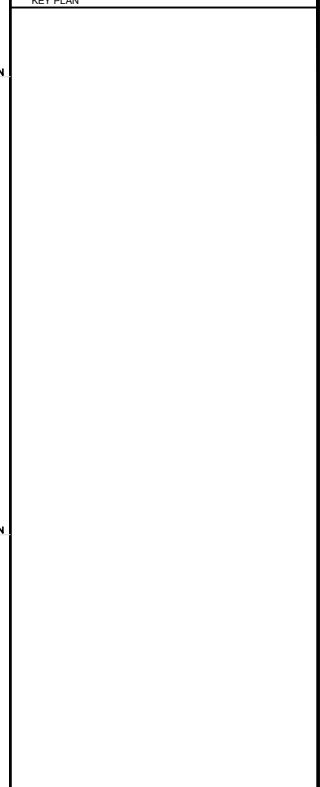
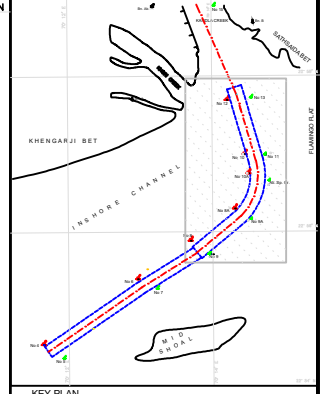
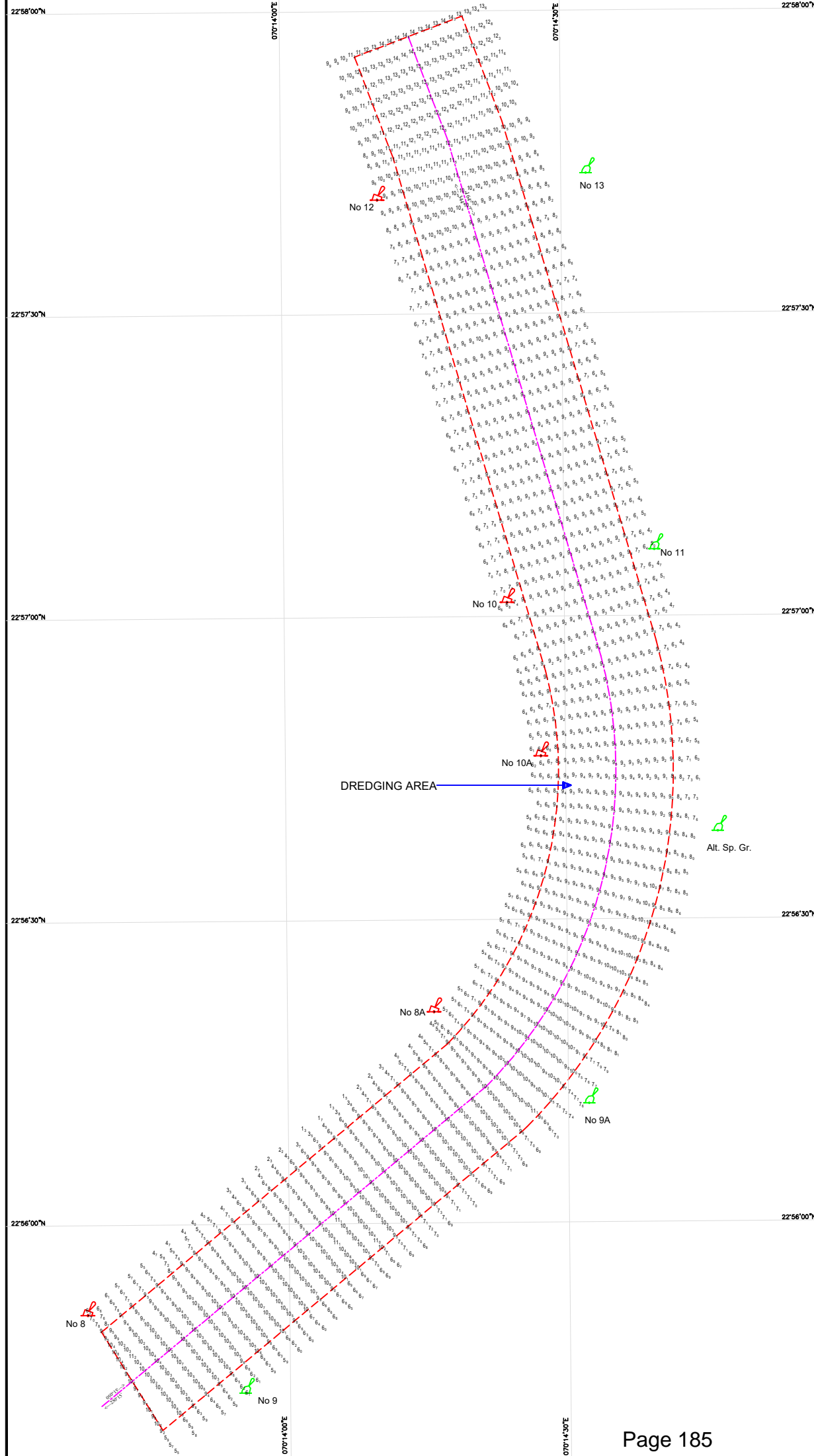

NOTES:
 * PROJECTION : UTM (ZONE - 42)
 * DATUM : WGS - 84
 * SOUNDINGS ARE IN METRES AND DECIMETERS REDUCED TO CHART DATUM WHICH IS 3.884m. BELOW MEAN SEA LEVEL.
 * 15 Min SHIFT APPLIED TO TIDE
 * ZONE II (Buoy No. 8 to 12)
 * Sounding Taken from DWG No: VO/KPT/MD/Z-II/2019/28 (RA 28)
 * Dredging area Length = 4.8 km and width = 350 m

DREDGING IN THE NAVIGATIONAL CHANNEL AND ALONGSIDE CARGO BERTHS / OIL JETTIES AT DEENDAYAL PORT TRUST YEAR 2020-2023

Drawing Number :
 AECOM-P&M-60619769-DWG-1025

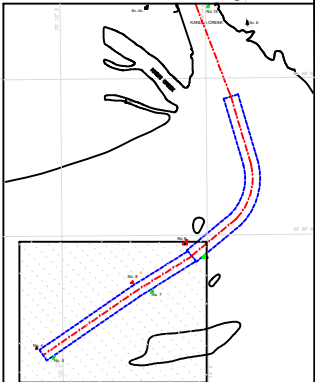
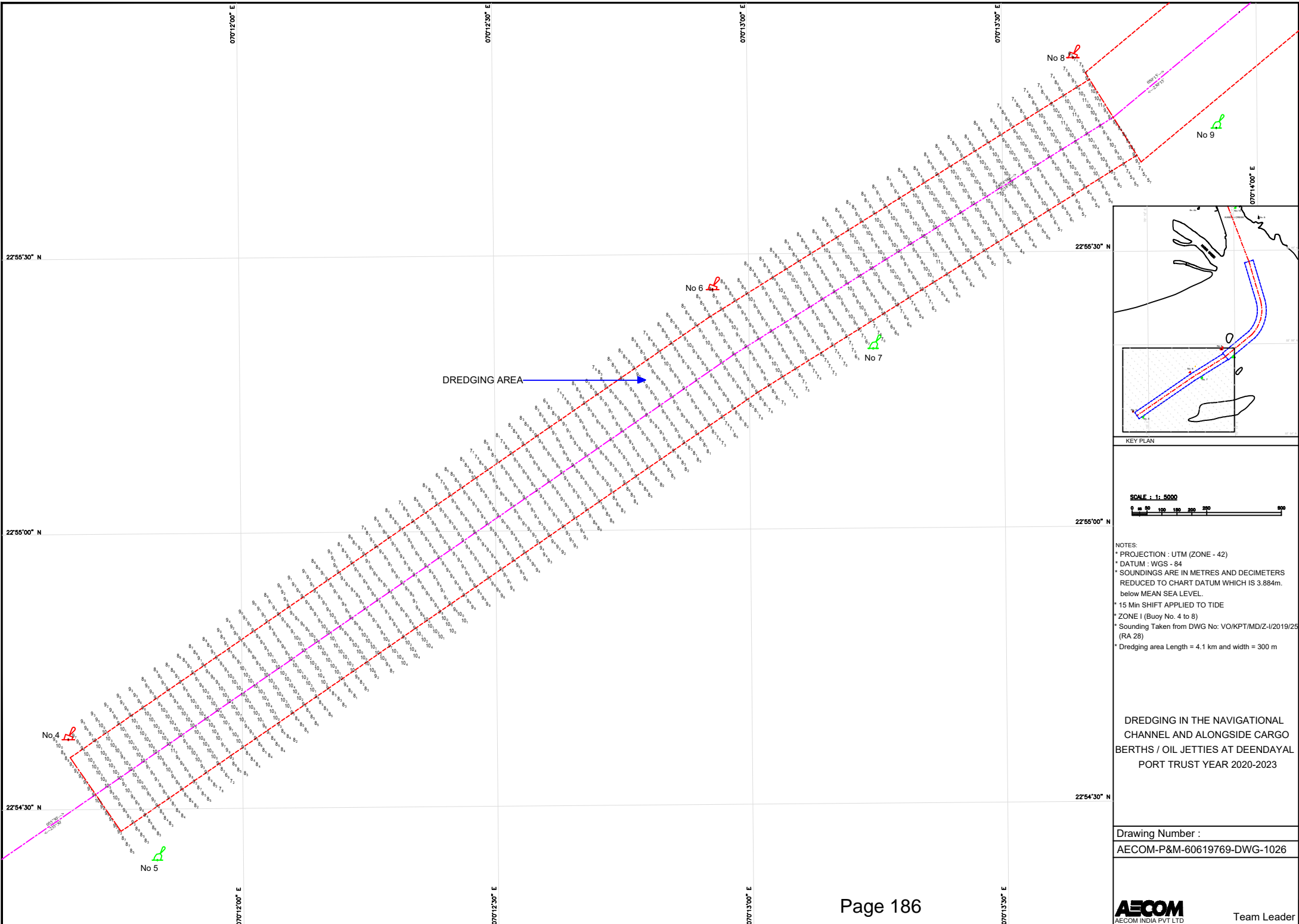

KEY PLAN

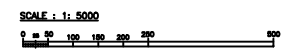

- NOTES:
- * PROJECTION : UTM (ZONE - 42)
 - * DATUM : WGS - 84
 - * SOUNDINGS ARE IN METRES AND DECIMETERS REDUCED TO CHART DATUM WHICH IS 3.884m. below MEAN SEA LEVEL.
 - * 15 Min SHIFT APPLIED TO TIDE
 - * ZONE I (Buoy No. 4 to 8)
 - * Sounding Taken from DWG No: VO/KPT/MD/Z-I/2019/25 (RA 28)
 - * Dredging area Length = 4.1 km and width = 300 m

DREDGING IN THE NAVIGATIONAL CHANNEL AND ALONGSIDE CARGO BERTHS / OIL JETTIES AT DEENDAYAL PORT TRUST YEAR 2020-2023

Drawing Number :
 AECOM-P&M-60619769-DWG-1026

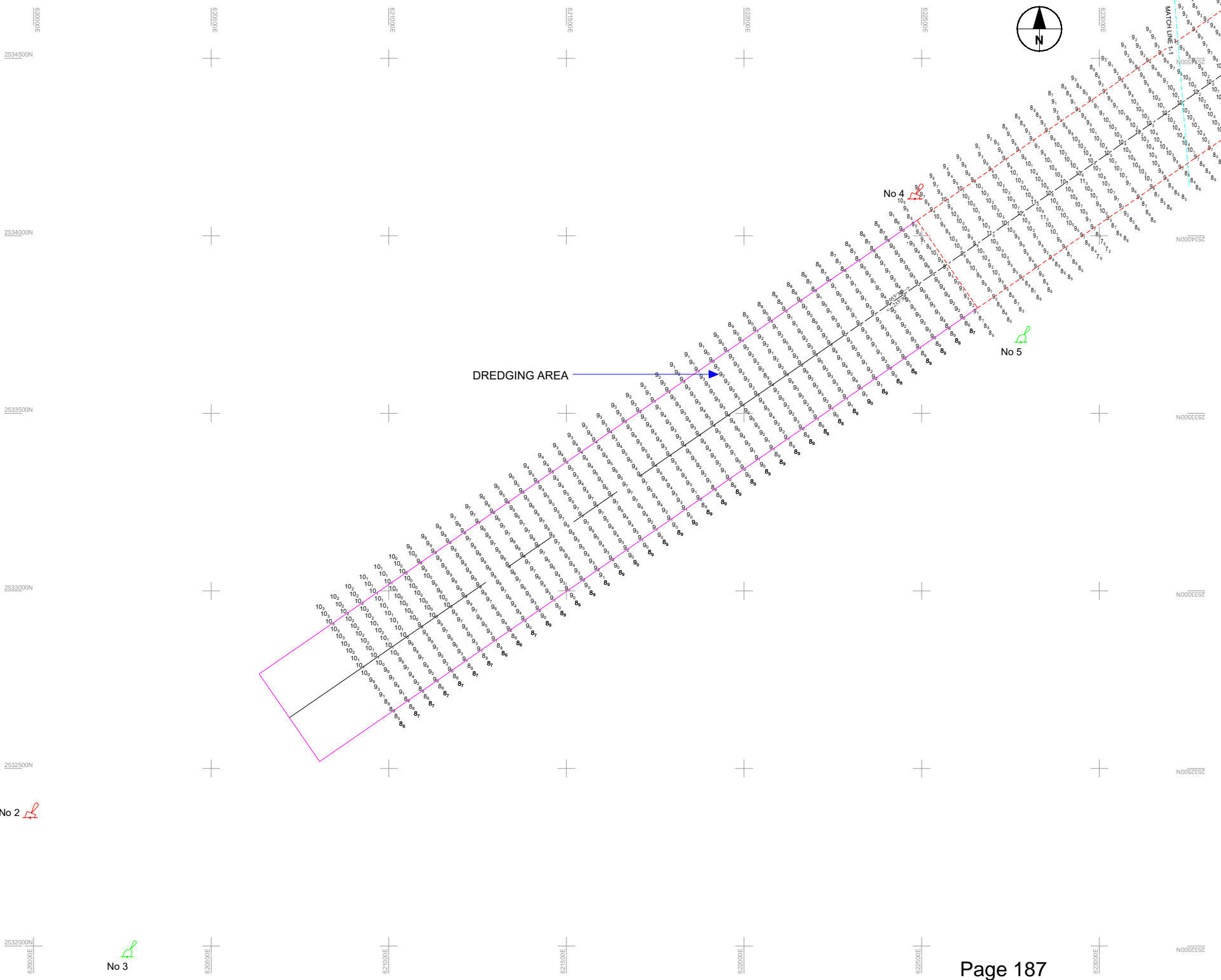

Notes :-
 * 1:5000 FULL SIZE A1
 * ZONE 1A (Buoy No.2 TO 4)
 * Dredging area Length = 2.25 km and width = 300 m

REV.	DATE	DESCRIPTION	DR.	CHK.	APP.
REVISION DETAILS					

OWNER:
DEENDAYAL PORT TRUST

PROJECT:
 DREDGING IN NAVIGATIONAL CHANNEL & ALONGSIDE CARGO BERTHS/ OIL JETTIES AT DEENDAYAL PORT TRUST FOR THE YEARS 2020-2023

PART/DISCIPLINE:
 PURPOSE:

DRAWING TITLE:

Kandla Navigational channel
 Zone 1A (BOUY 2 to 4)

DRAWING NUMBER:	REV.
AECOM-P&M-60619769 - DWG - 1015	0

AECOM
 AECOM India Pvt. Ltd.

No 3

SHEET 01 OF 01

DEENDAYAL PORT TRUST
KANDLA CREEK
SHEET No 2
FROM SOUTH OF OIL JETTIES
TO
BUOY No 12 & 13

NATURAL SCALE 1:8000



DREDGING IN THE NAVIGATIONAL CHANNEL AND ALONGSIDE CARGO BERTHS / OIL JETTIES AT DEENDAYAL PORT TRUST YEAR 2020-2023

- Note:**
- Datum: WGS 84
 - Projection: UTM Co-ordinates with the local origin at the reference station on top of Seva Sadan III 23° 00' 35.5570N, 70° 13' 18.4070E.
 - Soundings are reduced to Local Chart Datum which is 3.884m. below MSL. For information regarding tides, see tide tables for the Port of Kandla published annually.
 - Maintenance Dredging at cargo berth 1 to 16 (Design Depth = 11 to 14.1m BCD) (Length = 3.75 km and max. width = 45 m)
 - Zero Panel (Design Depth = 4 m BCD), Bunder Basin (Design Depth = 0BCD)
 - Maintenance Jetty (Design Depth = 6 m BCD)
 - Capital Dredging at SNA Jetty (Design Depth = 6 m BCD)
 - Sounding Taken from HS No. 3666

Drawing Number :	Team Leader
AECOM-P&M-60619769-DWG-1018	
AECOM AECOM India Pvt. Ltd.	

Dredging Area at Cargo Berth
 1 to 16 and Zero Panel

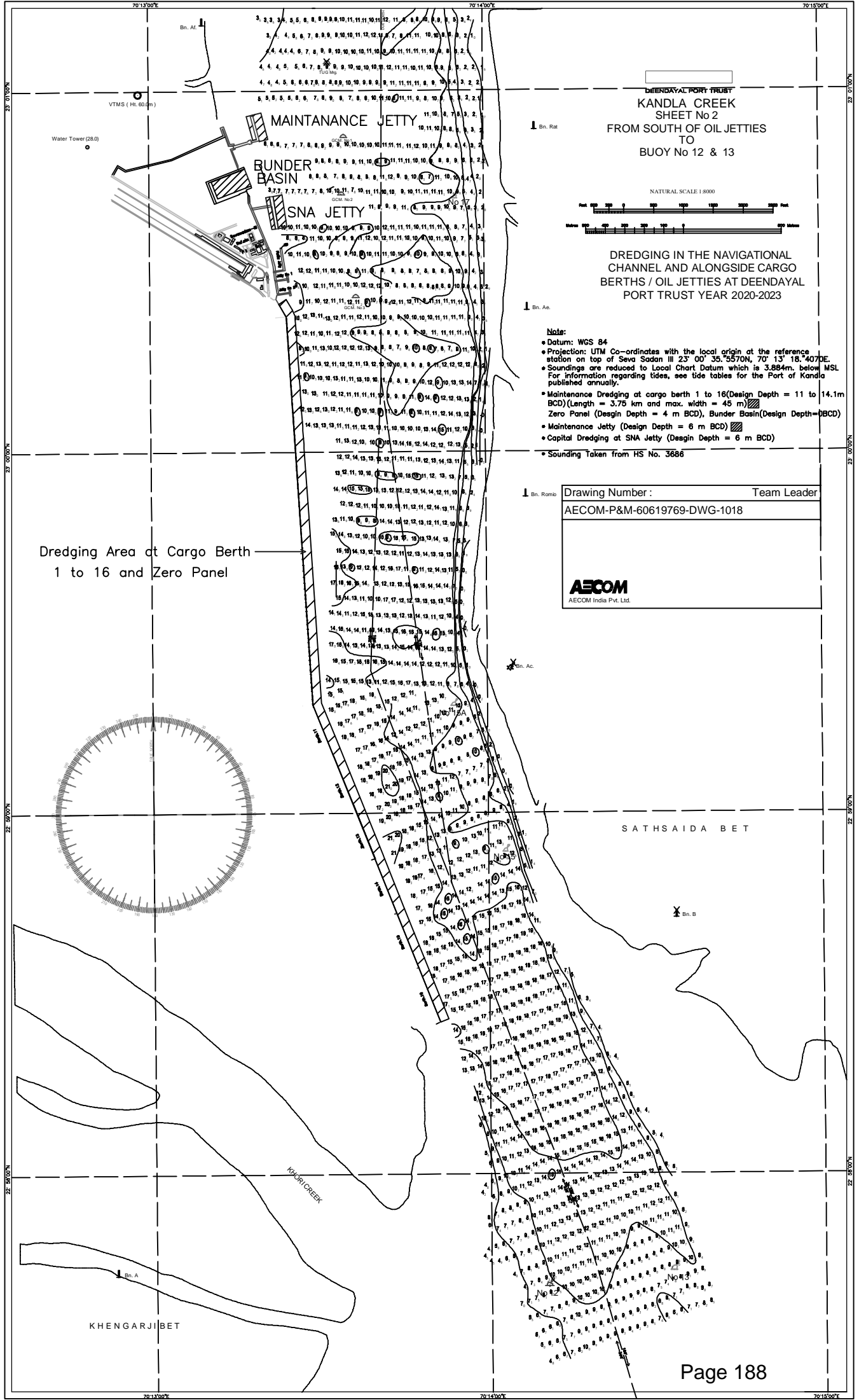
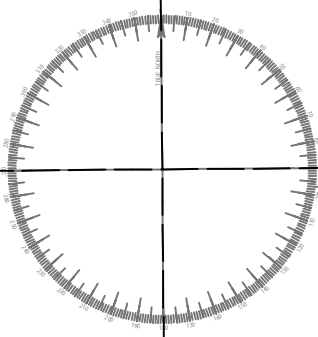

DEENDAYAL PORT TRUST

KANDLA CREEK SHEET No 1 FROM MOUTH OF PHANG & SARA CREEK TO SOUTH OF OIL JETTIES

NATURAL SCALE 1:8000



DREDGING IN THE NAVIGATIONAL
CHANNEL AND ALONGSIDE CARGO
BERTHS / OIL JETTIES AT DEENDAYAL
PORT TRUST YEAR 2020-2023

Jafarwan bunder

SARA CREEK

DUMPING
GROUND

PHANG CREEK

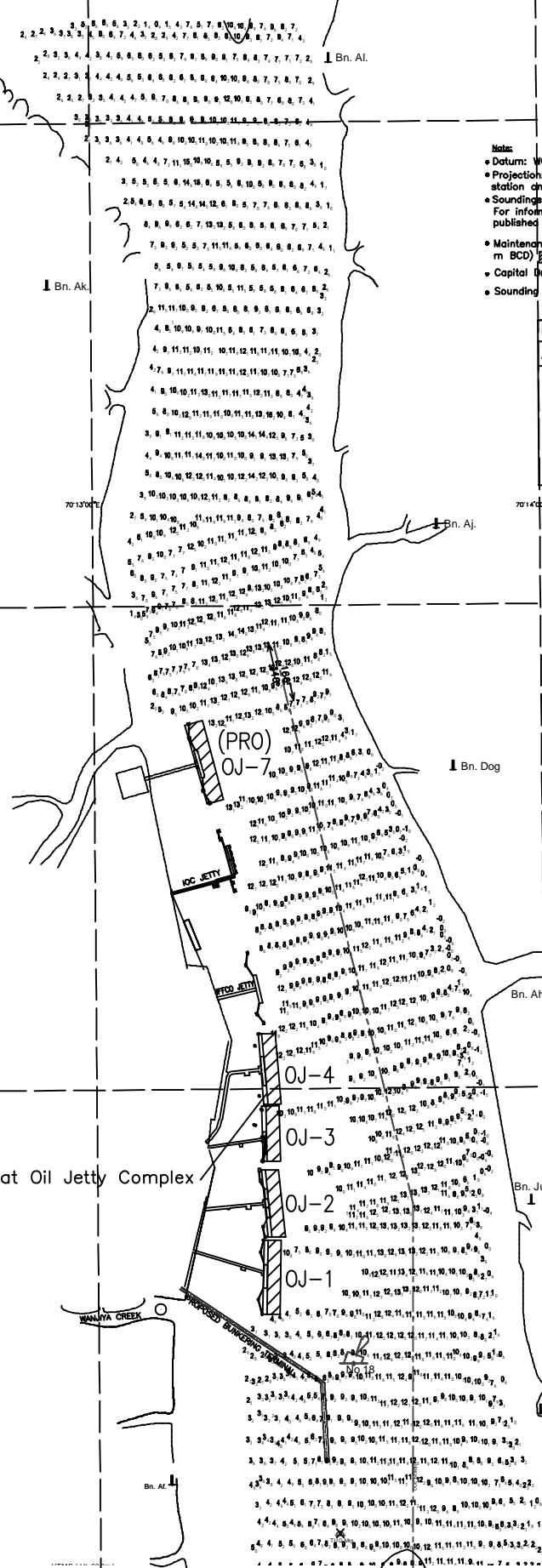

- Note:**
- Datum: WGS 84
 - Projection: UTM Co-ordinates with the local origin at the reference station on top of Sawa Sadan III 23° 00' 35.15570N, 70° 13' 18.74070E.
 - Soundings are reduced to Local Chart Datum which is 3.884m. below MSL. For information regarding tides, see tide tables for the Port of Kandla published annually.
 - Maintenance Dredging at Oil Jetty 1 to 4 (Design Depth = 11.5 to 11.8 m BCD) [diagonal hatching]
 - Capital Dredging at Oil Jetty No. 07 (Design Depth = 14.1 m BCD) [cross-hatching]
 - Sounding Taken from HS No. 3685

Drawing Number :
AECOM-P&M-60619769-DWG-1017

AECOM
AECOM India Pvt. Ltd. Team Leader

Dredging Area at Oil Jetty Complex

C A R G O B E R T H S

Depth 9

Depth 10

8
9
10

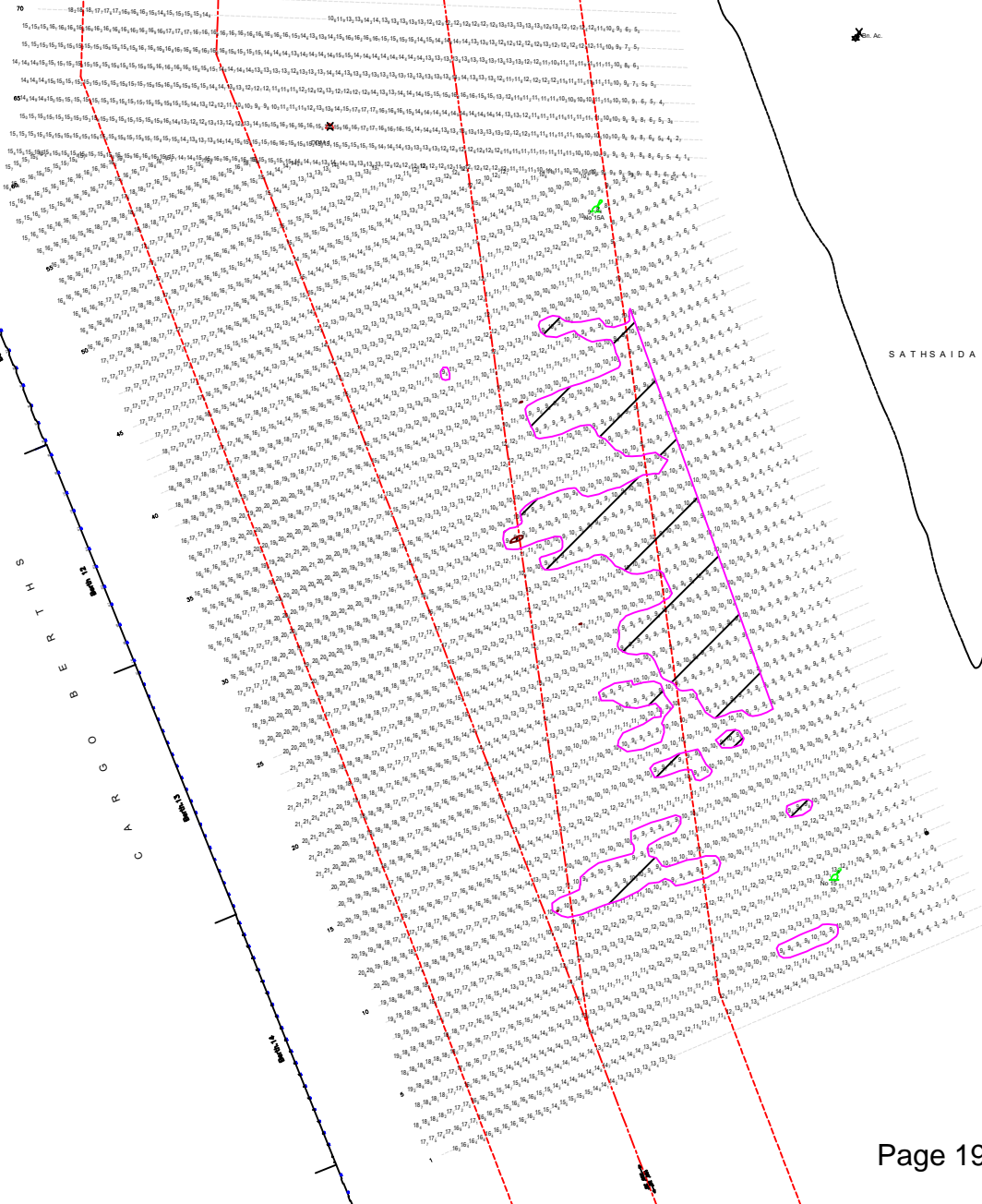

SATHSAIDA BET

SHILREBB

C A R G O B E R T H S

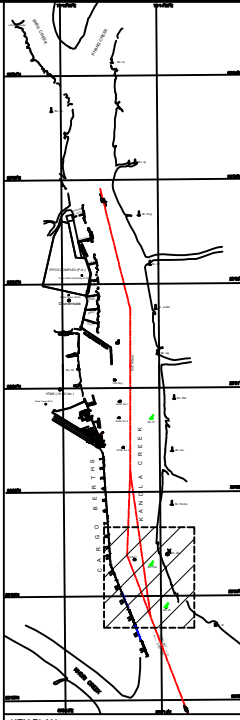

KEY PLAN

SCALE 1:1,200

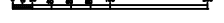

- NOTES:
- * PROJECTION: UTM (ZONE -42)
 - * DATUM: WGS 84
 - * SOUNDINGS ARE IN METRES AND DECIMETERS REDUCED TO CHART DATUM WHICH IS 3.884m. BELOW MEAN SEA LEVEL.
 - * Proposed Dredging area in kandla creek patches, 9.0 m TO 10 m
 - * Sounding Taken from DWG No : VDKPT/CDK/POST/GRID/2020/S-101

DREDGING IN THE NAVIGATIONAL CHANNEL AND ALONGSIDE CARGO BERTHS / OIL JETTIES AT DEENDAYAL PORT TRUST YEAR 2020-2023

Drawing Number :
AECOM-P&M-60619769-DWG-1019

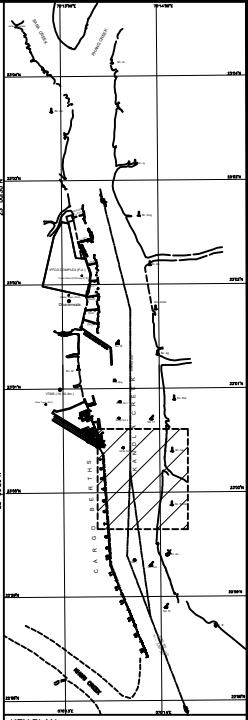

KEY PLAN



- NOTES:
- PROJECTION : UTM (ZONE - 42)
 - DATUM : WGS - 84
 - SOUNDINGS ARE IN METRES AND DECIMETERS REDUCED TO CHART DATUM WHICH IS 3.884m. BELOW MEAN SEA LEVEL.
 - Proposed Dredging area in kandla creek patches, 9.0 m TO 10 m
 - Sounding Taken from DWG No : VO/KPT/CD/KC/POST/GRID/2020/S-202

DREDGING IN THE NAVIGATIONAL CHANNEL AND ALONGSIDE CARGO BERTHS / OIL JETTIES AT DEENDAYAL PORT TRUST YEAR 2020-2023

Drawing Number :
AECOM-P&M-60619769-DWG-1020

AECOM
AECOM INDIA PVT. LTD. Team Leader